



Model RVW32

ASME HOT WATER SAFETY RELIEF VALVE

(10321 Series)

Job Name:	Contractor:
Job Location:	P.O. Number:
Engineer:	Representative:
Tag:	Wholesale Distributor:

DESCRIPTION

ASME Section IV Safety Relief Valve for protection of small hot water heating boilers and hydronic heating systems. Made from proven ASTM grade Brass and Bronze materials with decorative chrome finish.

FEATURES

- ASME Certified Capacity
- 20-60 psig (1.4 – 4.1 bar) Set Pressure @ 312°F(155°C) max
- Corrosion Resistant Construction
- Polished Chrome Finish
- Directive 97/23/EC (PED) Compliance Available
- MADE IN THE USA



MATERIALS

Body: ASTM B16 Brass
 Nozzle: ASTM B62 Bronze
 Spring: Stainless Steel
 Seat: EPDM

OPTIONS

Set pressure (20-60, psig)

CAPACITY

SET PRESSURE PSIG (bar)	10-321 CAPACITY BTU/Hr
20 (1.38)	325,000
25 (1.72)	375,000
30 (2.07)	425,000
35 (2.41)	475,000
40 (2.76)	525,000
45 (3.10)	575,000
50 (3.45)	625,000
55 (3.79)	675,000
60 (4.14)	725,000

DIMENSIONS

Model #	Series #	SIZE	A	B	C	D
RVW32	10321	3/4M x 3/4F	1.81 (46)	3.69 (94)	1.38 (35)	1.56 (40)

All dims in inches (mm)

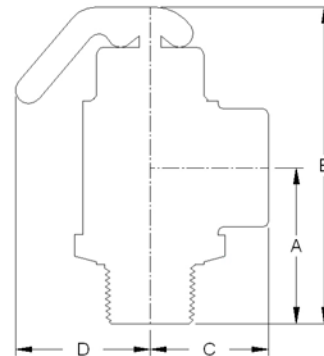

APPROVALS



ASME Section IV
 Canadian Registration Number 0G8547.5C

Conbraco Industries, Inc. 701 Matthews Mint Hill Rd. Matthews NC 28105 USA ; www.apollovalves.com ; 704-841-6000

This specification is provided for reference only. Conbraco reserves the right to change any portion of this specification without notice and without incurring obligation to make such changes to Conbraco products previously or subsequently sold.